



THE
OPERATIONAL
RESEARCH
SOCIETY

OR66 Delegate Information Pack

10-12 SEPTEMBER 2024

Bangor University





CONTENTS

PAGE 1 **Welcome to Bangor University**

PAGE 2 **Conference Information**

PAGE 3 **Campus Facilities**

PAGE 4 **Conference Registration**

PAGE 5 **Travelling to the Conference**

PAGE 6 **Accommodation Information**

PAGE 7 **General Safety**



Copyright: Starling Skies



Copyright: Bangor University



Copyright: Bangor University



Copyright: Bangor University

WELCOME TO BANGOR UNIVERSITY

We are delighted that you will be joining us for the OR66 Annual Conference, which will be taking place this year on the 10th-12th September at Bangor University in North Wales. Nestled amidst the stunning natural landscapes of North Wales, Bangor University's campus is a picturesque haven for academia and innovation. Delegates have travelled from across the world. We look forward to sharing a diverse and stimulating programme with you.

This brochure provides all the essential information you need to make the most of your conference experience. From travel tips to the University campus, details on finding your accommodation, and an overview of the onsite facilities, we've got you covered.

You can also download a **campus map** to help navigate your way around once you arrive.

The conference programme will be held in The Main Arts building, with accommodation located across the Ffriddoedd site on the University's main student residential campus.

Breakfast and dinner (excluding the gala dinner) will be served at Bar Uno. All venues are within a short walking distance of each other.

We hope that you have an enjoyable and valuable time at the conference. If there is anything we can do to help you, then please let us know.

CYNLLUN LLAWR PRIF ADEILAD Y CELFYDDYDAU MAIN ARTS BUILDING FLOOR PLAN

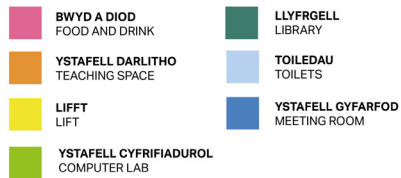

ISLAWR PRIF ADEILAD Y CELFYDDYDAU
MAIN ARTS BASEMENT FLOOR



LLAWR MESANIN PRIF ADEILAD Y CELFYDDYDAU
MAIN ARTS MEZZANINE FLOOR

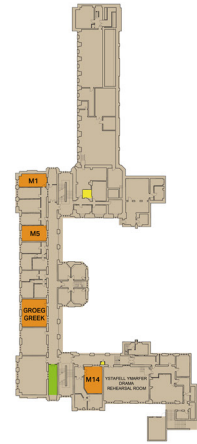

LLAWR GWAELOD PRIF ADEILAD Y CELFYDDYDAU
MAIN ARTS GROUND FLOOR



LLAWR CYNTAF PRIF ADEILAD Y CELFYDDYDAU
MAIN ARTS FIRST FLOOR

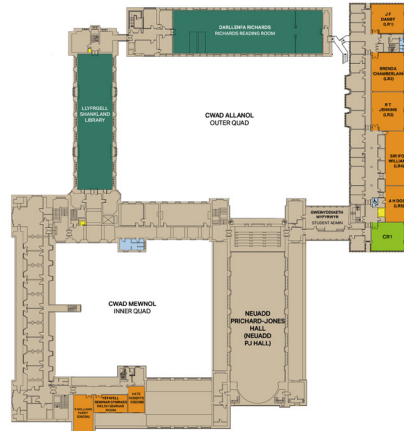

LEFEL 3 CELFYDDYDAU NEWYDD
LEVEL 3 NEW ARTS

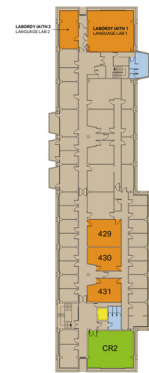

CONFERENCE INFORMATION

PROGRAMME:

A provisional programme is available on the OR Society website: bit.ly/AnnualConferenceOR66. A final version will be available on the event app a few days prior, and copies will be provided at the conference.

The Main Arts building is the primary location for the conference and is split over 3 floors which is where the parallel sessions will be taking place.

Posters and Plenary presentations all take place in the **Eric Sunderland Lecture Theatre**. Registration, exhibitors and sponsors are all situated in the main foyer. Refreshments will be served outside the **Neuadd Prichard Jones Hall** during breaks.

CAMPUS FACILITIES

CAMPUS MAP:

Links to the campus map can be found here:

- [parking-map-en.pdf \(bangor.ac.uk\)](#)
- [Campus Map | Bangor University](#)

PLACES TO EAT, DRINK AND SHOP ON CAMPUS:

Further information can be found on the University website here: [Places to Eat and Drink | Commercial Services | Bangor University](#). Please note that opening times for some of these might differ outside of term time.

The nearest ATM is in Morrisons which is based between the Ffriddoedd Village (halls accommodation) and Main Arts Building. This will also be the closest shop for delegates.

ADDITIONAL CAMPUS FACILITIES:

Brailsford Sports Centre is located in Ffriddoedd and they currently offer £12 weekly passes to use their gym. <https://www.bangor.ac.uk/sportbangor>

Pontio local cinema and Arts Centre information can be found here:

<https://tickets.pontio.co.uk/Online/default.asp>

LOCAL BUS SERVICES:

Bangor Bus Station is located on Garth Road (next to Marks and Spencer). Each route has a number, which is displayed at the bus stop and on the bus itself. Two bus services operate in Bangor Arriva and Padarn. Timetables can be obtained at the bus station or on the bus services' websites:

www.arrivabus.co.uk/
www.padarnbus.co.uk

Please note that both the **5, X5 and 42 buses** go to Ffriddoedd Campus.

LOCAL ATTRACTIONS:



The counties of Gwynedd, Anglesey and Conwy offer a wide range of tourist attractions. Caernarfon and Conwy, for example, are historic castle walled towns by the sea.

The small seaside town of Beaumaris on Anglesey, offering spectacular views of the Menai Strait and the mountains of Snowdonia, is popular with tourists and, more importantly perhaps for socio-legal scholars, has a historic court museum and a prison museum.

North Wales offers the combination of seaside and alpine mountains. Up Mount Snowdon is a popular walk, rewarding the hardy with a lasting experience. The less physically fit can take the narrow-gauge train to the summit.

Railway fans will be able to spend days travelling on steam-hauled trains in North Wales if they wish so. At the foot of Mount Snowdon, the town of Llanberis has an excellent slate mine museum, exemplifying work and living conditions in the industrial past.

Beaches and dunes stretching for many miles invite the keen walker. A coastal path leads around Anglesey and mainland Wales. Sea birds, grazing ponies and – with luck and depending on the location – sea turtles, seals and dolphins can be spotted.

Further information about local attractions can be found here: www.visitwales.com/destinations/north-wales

CONFERENCE REGISTRATION

Registration will be open from 8am each morning in the foyer of the **Main Arts Building** on the Ground Floor and will be staffed until the last session has taken place each day.

You will receive a name badge and conference bag upon registering. Please always wear your delegate badge throughout the conference as this will give you access to conference services and sessions.

MEALS:

All delegates will receive lunch and refreshments as part of their conference ticket which will be served in the **Neuadd Powis Hall** in the **Main Arts Building**.

For those who have booked accommodation, dinner will be served on Monday evening (for an additional fee) and Tuesday evening in **Bar Uno**. Breakfast will also be served in the same location from 7am-8:30am.

Bar facilities will be available until late all evenings of the conference for delegates.

SOCIAL TRIPS:

These will be taking place on the Tuesday afternoon from 5-7:30pm and are included in your ticket price. All full conference/Tuesday day tickets should have received an email to register for one of these trips. Please arrive outside the **Main Arts Building** for **4:45pm** before being walked over to the coaches.

For those who have purchased a full conference ticket and opted to attend the Gala Dinner, this will be taking place on the Wednesday evening in the Prichard-Jones

Hall in the **Main Arts Building**. This will start from 7pm with a drinks reception and go on late into the evening with a dancefloor and disco.

DRESS CODE:

There isn't a set dress code for OR66, however, delegates usually opt to dress professionally in smart-casual clothing. For the Gala Dinner delegates tend to dress a little more formally, although the choice is very much yours.

ASSISTANCE DURING THE CONFERENCE:

For any non-urgent enquiries, either email **event.enquiry@theorsociety.com** or during conference hours please report to the conference registration desk and a member of staff will be on hand to support.

For more urgent enquiries i.e., travel issues meaning that you are unable to deliver your talk, please call **+ 44 0777 192 7685**.

If you have any accessibility requirements which you have not informed us about on the registration form, please let a member of OR Society staff know as soon as possible.

HEALTH AND SAFETY:

If out of hours, please call Security if you (or someone else) require First Aid on **01248 382795**.

If it is during the day, please find a member of OR Society staff and they can either administer First Aid or locate an appropriate staff member.

Information on fire evacuation points/procedures will be shared with delegates at the venue.





TRAVELLING TO THE CONFERENCE

BY AIR

Manchester International Airport is the most convenient UK entry point for Bangor.

- You can either get a direct train from the Airport Station to Bangor
- or change at Llandudno Junction/Chester/Crewe.

Other airports with good rail links to Bangor include **Birmingham International, Liverpool John Moores and any London airport.**

More information can be found here:
[Travelling to Bangor | Bangor University](#)

BY TRAIN

Bangor train station is located on Station Road. There are direct trains to Bangor Station from London Euston, Manchester (Airport & Piccadilly Stations), Birmingham New Street, Crewe, Chester and Cardiff Central.

Estimated train journey times to Bangor:

- **Liverpool** - 1.5 hours
- **Manchester** - 2 hours
- **Birmingham** - 3 hours
- **London** - 3 hours
- **Cardiff** - 4 hours

TAXI

As some of these services are less frequent than others, we would advise using the Trainline app for latest train timetables and to book tickets. Please find below a list of taxi companies in and around Bangor:

- **A5 Taxis:** 01248 360 360
- **Ace Taxis:** 01248 371 717
- **Chubbs Cabs:** 01248 353 535
- **Classic Cabs:** 01248 370 717
- **Owen's Mini Coaches:** 01248 602 260 / www.owenswales.co.uk
- **Tryfan Cabs Ltd.:** 01248 370 127

The University address is: **Bangor University, Bangor, Gwynedd, LL57 2DG**

There are good road links to Bangor along the north Wales coast from the M56 and M6.

No permits will be required for parking. There is parking available around the Ffriddoedd accommodation village and along College Road (just follow signposts to the carparks). **Please note that there are limited parking spaces outside the Main Arts Building.**



Copyright: Bangor University

ACCOMMODATION INFORMATION

Accommodation is situated in Ffriddoedd village and more information can be found here:

www.bangor.ac.uk/commercial-services/documents/guest-information.pdf

CHECK IN:

General check in is from 11am-5pm. If you arrive in this period, please collect your room key from the Halls Office which is situated in the **Idwal Building**, Bangor, LL57 2GP.

If you arrive after 5pm you will need to collect your key from the **Ffriddoedd Site Security Lodge** which is open 24 hours a day.

DEPARTURE:

Your keys must be returned to the Halls Reception by 9:30 am on the day of your departure. If it is before 9:00 am please drop off your keys at the Security Lodge.

BREAKFAST:

For those who have selected bed and breakfast, this will be served in **Bar Uno** from 7am-8:30am.

FACILITIES:

Tea and coffee making facilities (in the kitchen), free Wi-Fi, bed linen and towels are provided.

You will have access to shared kitchen facilities, which contain a fridge, freezer, hob, oven, microwave, toaster, and kettle. The University does not provide any kitchen utensils, crockery, or cutlery.

In addition, there are two, card-operated launderettes for guest use, one near Halls Reception, the other opposite the Security Lodge.

Guests can purchase cards from a machine in the Security Lodge. An on-line top up system is then available.

Wi-Fi is available through Eduroam or ResNet with login details in each bedroom.

The heating is on a timer. Please check the heater socket is 'ON' before reporting heating problems. In addition, never cover electric heaters or dry items on them as they could burn.

GENERAL SAFETY: IN AN EMERGENCY/ FIRE EVACUATION

FIRE SAFETY

Do not use aerosols close to smoke detectors. Fire alarms are tested weekly in the afternoon, ringing for a short interval only. If you hear the fire alarm at any other time, or it is continuous please evacuate as detailed over the page.

Please familiarise yourself with the Fire Evacuation Procedure displayed in your room and keep fire routes and Fire Exits clear at all times. In addition, do not burn candles, incense or similar and **NEVER cover smoke detectors. Guests covering detectors will be asked to leave immediately.**

SMOKING

The University prohibits smoking and electric smoking devices in and within 5 metres of University buildings.

SHOWER

Please keep the shower room door closed as steam from hot water can activate the fire system.

ELECTRICITY

Guests may only use standard electrical equipment such as hair dryers, shavers, laptops and phone chargers. Please remember to switch off heating appliances after use and never leave unattended e.g. room heater, hair dryers, and kettle. If you have a problem with University electrical equipment please call the Halls Reception, Monday to Friday, 9am – 5pm. Outside of these hours please contact Security.

Safety & Security

Secure your bedroom and corridor door at all times. Do not leave valuables in open view and call Security immediately if you have concerns or see anything suspicious.

Personal Possessions

Please do not leave personal items in the corridors or kitchen. The University has advised that items not reclaimed in 3 months will be disposed of.

IF YOU DISCOVER A FIRE:

Operate the nearest call point and evacuate immediately.

IF THE FIRE ALARM SOUNDS:

- Do not use the lift.
- Leave the building by the nearest Fire Exit (do not stop to collect personal items).
- Go to the Assembly Point and await further instruction.
- Never re-enter the building until authorized by the fire brigade or University security staff.

IF YOU CANNOT EVACUATE VIA THE STAIRS:

- Go to the Refuge Point.
- Operate the system – it links to Security.
- Await further instructions from Security.

USEFUL NUMBERS:

University Security Lodges:

01248 - 38 3472 / 38 2795 / 38 8041 (24hrs)

Conference Office:

01248 38 8088 (Mon- Fri 9am – 5pm)

Halls Reception: 01248 388593

(Mon- Fri 9am-8pm. Weekend 2pm – 8pm)

In an emergency (e.g. First Aid) call Security on **3472 / 2795 / 8041** if using the building's foyer phone or the above **01248** numbers if using a mobile. **333** also **links to Security** and is our equivalent of 999.

CYNLLUN LLAWR PRIF ADEILAD Y CELFYDDYDAU MAIN ARTS BUILDING FLOOR PLAN

- BWYD A DIOD
FOOD AND DRINK
- LLYFRGELL
LIBRARY
- YSTAFELL DARLITHO
TEACHING SPACE
- TOILEDAU
TOILETS
- LIFFT
LIFT
- YSTAFELL GYFARFOD
MEETING ROOM
- YSTAFELL CYFRIFIADUROL
COMPUTER LAB

ISLAWR PRIF ADEILAD Y CELFYDDYDAU
MAIN ARTS BASEMENT FLOOR

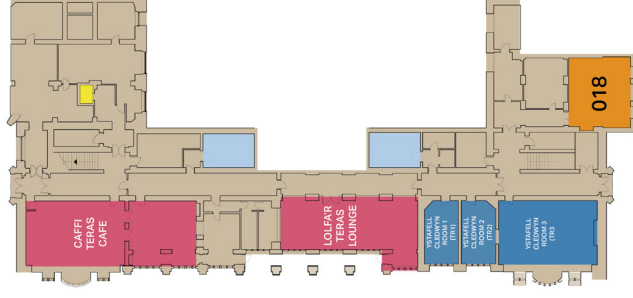

LLAWR MESANIN PRIF ADEILAD Y CELFYDDYDAU
MAIN ARTS MEZZANINE FLOOR

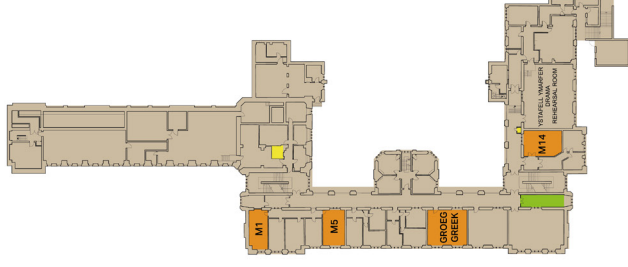

LLAWR GWAELOD PRIF ADEILAD Y CELFYDDYDAU
MAIN ARTS GROUND FLOOR



LLAWR CYNTAF PRIF ADEILAD Y CELFYDDYDAU
MAIN ARTS FIRST FLOOR



LEFEL 3 CELFYDDYDAU NEWYDD
LEVEL 3 NEW ARTS

